

SubConn® Low Profile

3 and 4 contacts

Connector specifications

Single contact rating	600 V AC rms
DC rating	85% of above AC rating
3 contacts current rating	10 A per contact (max 30 A per connector)
4 contacts current rating	10 A per contact (max 40 A per connector)
Insulation resistance	> 200 Mohm
Contact resistance	< 0.01 ohm
Wet matings	> 500
Temperature rating (water)	- 4 to 60°C, 25 to 140°F
Temperature rating (air)	- 40 to 60°C, - 40 to 140°F
Storage temperature rating	- 40 to 60°C, - 40 to 140°F
Depth rating	700 bar, 10,000 psi
Depth rating PEEK	300 bar, 4,350 psi

Material specifications

Connector body	Chloroprene rubber
Bulkhead body	Brass, stainless steel, titanium, anodised aluminium or PEEK
Contacts	Gold plated brass UNS - C36000
O-rings	Nitrile
Locking straps	Chloroprene rubber
Inline cable (60 cm, 2 ft)	16 AWG 1.31 mm ² chloroprene rubber
Bulkhead leads (30 cm, 1 ft)	18 AWG 0.82 mm ² tagged PTFE

Face view (male)

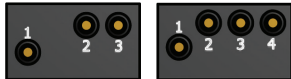

Inline cable colour code

- 1 Black
- 2 White
- 3 Red
- 4 Green

(3 conductor cable colour code: 1 black, 2 white, 3 green)

Nominal cable outside diameter (OD)

- 3 conductor cable 0.385", 9.8 mm
- 4 conductor cable 0.410", 10.4 mm

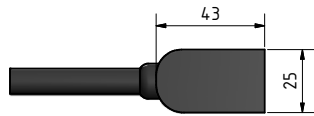

LPIL3F

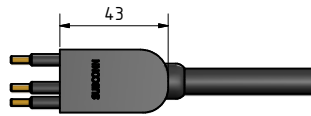

LPIL3M

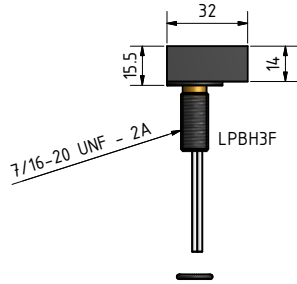
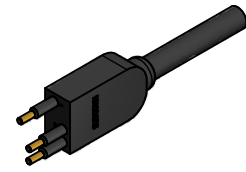

LPBH3F

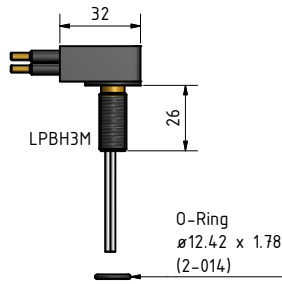

LPBH3M

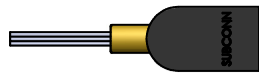
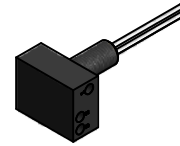

LPOM3F

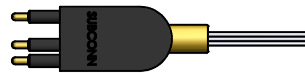

LPOM3M

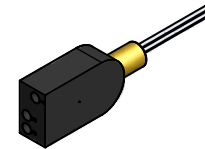

LPDC3F



LPDC3M

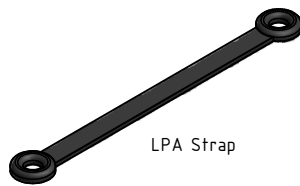
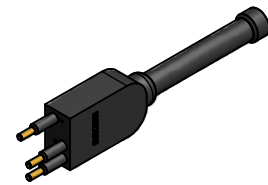

LPA Strap

Drawing information

Dimensions in mm (1 mm = 0.03937 inch)
Threads in inches (1 inch = 25.4 mm)